

NOTES: 1) 10' SIDE SETBACKS SHOWN BASED UPON 2-STORY CONSTRUCTION
 2) UTILITY AND DRAINAGE EASEMENTS NOT SHOWN.

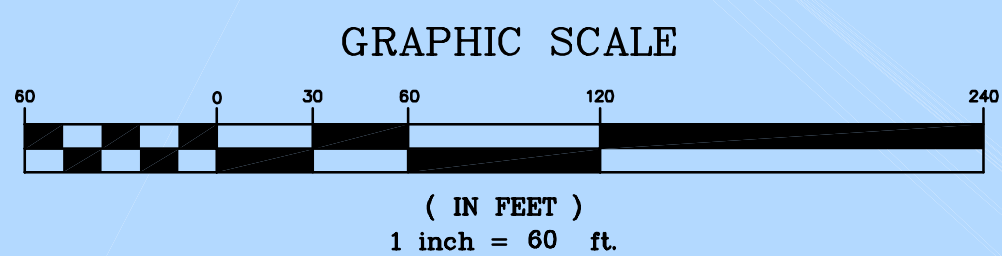

LEGEND

- TRAFFIC CIRCLE APRON
- GREEN SPACE AREA
- WETLANDS
- LOT AREA
- PROPOSED ROADWAY
- PROPOSED PARK
- LOT LINE
- WETLAND LINE
- ROW LINE
- 14 LOT NUMBER
- BLDG SETBACK LINE
- PROPERTY LINE

- BAY TREE
- OAK TREE
- PINE TREE
- MAGNOLIA TREE
- SIKAMORE TREE
- MULBERRY TREE
- PALM TREE

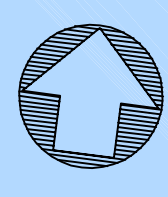
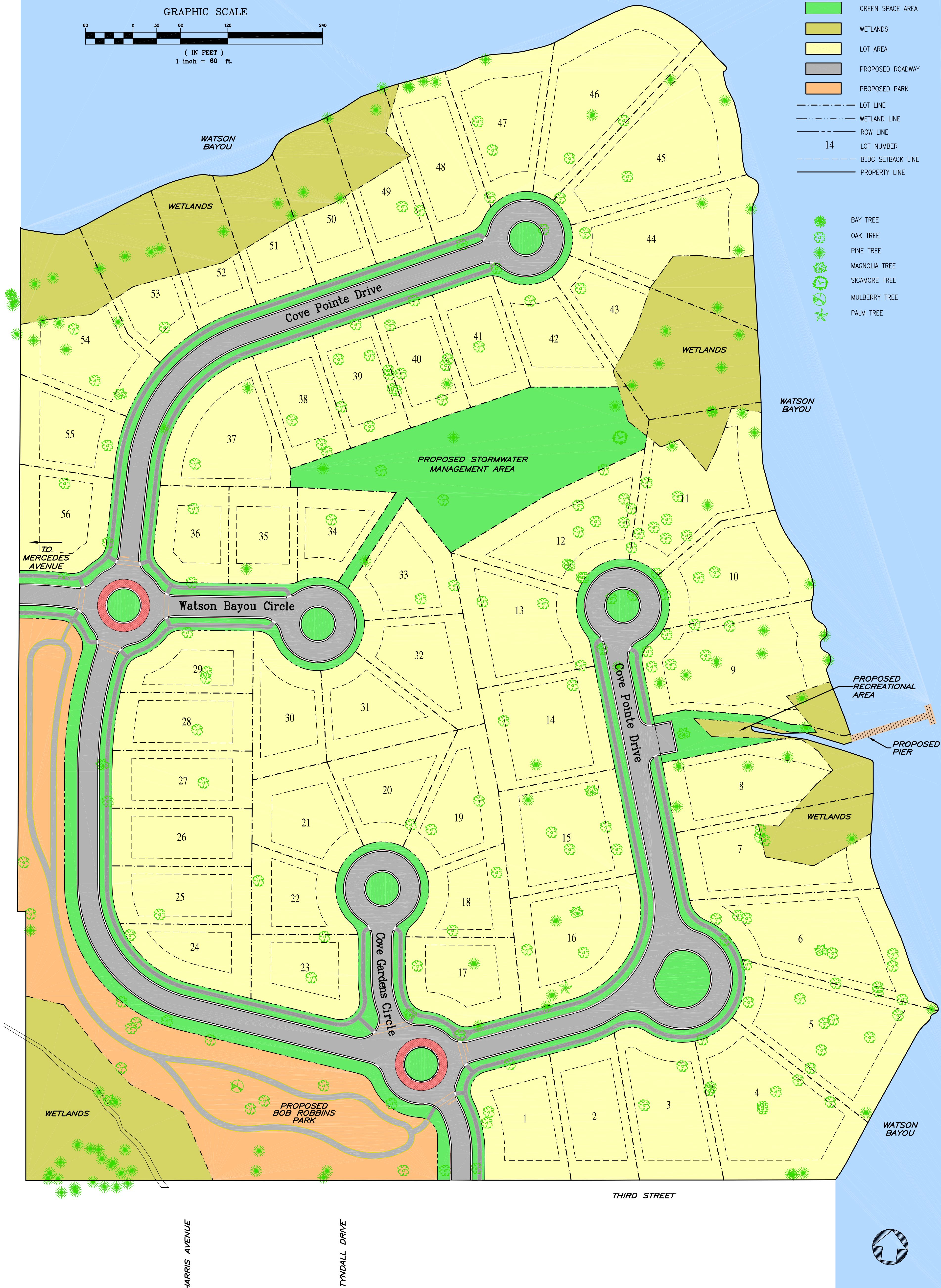

A-2

OVERALL SITE PLAN
 W/ TREE LOCATIONS

PROJECT NO: 76001.01	This drawing is the property of BASKERVILLE-DONOVAN, INC. and is not to be reproduced in whole or in part. It is not to be used on any other project and is to be returned upon request. NOT RELEASED FOR CONSTRUCTION BY DATE
DESIGNED BY: DEC/JCP	
DRAWN BY: JCP	
CHK'D BY: DEC	
PROJ. MGR: DEC	
DATE: AUGUST 2004	BY DATE

NO.	DATE	APPR.	REVISION/ACTION TAKEN

COVE POINTE
 COVE PRESERVATION
 PARTNERS, INC.

BASKERVILLE-DONOVAN, INC.
 INNOVATIVE INFRASTRUCTURE SOLUTIONS
 PENSACOLA ■ PANAMA CITY ■ TALLAHASSEE
 MOBILE ■ BREVARD ■ SARASOTA
 109 WEST 5th STREET
 PANAMA CITY, FLORIDA 32401 (850)769-2890
 ENGINEERING BUSINESS: EB-0000340